



DiamaPro[®]
SYSTEMS

OWNER'S MANUAL

SCR-394

WALK-BEHIND FLOOR SCRAPER



OPERATION & MAINTENANCE MANUAL

SAVE THESE INSTRUCTIONS FOR FUTURE REFERENCE



WARRANTY REGISTRATION CARD

Form must be completed and submitted within 30 days from the date of purchase.

Customer Information

First and Last Name

Company Name

Address

City

State

Zip Code

Phone Number

Email

Machine Information

Machine Type

Machine Model

Serial #

Purchase Date (dd/mm/yy)

Diamapro Systems®
3343 Peachtree Road NE
Suite 145 #24
Atlanta, GA 30326

INTRODUCTION

This manual guarantees the safe and efficient use of the machine. This manual is part of the machine and has to always be kept near the machine and be accessible for the operating personnel at all times.

The operating personnel have to have carefully read and understood this manual before any work commences. Prerequisite for safe working is the compliance with all the safety and handling instructions in this manual. Furthermore, the local accident prevention regulations and the general safety conditions for the use of the machine are applicable. Illustrations in this manual are for the purpose of explanation and may differ from the actual design of the machine.

When passing the machine on to third parties this manual must be included. All of the instructions and technical specifications in this manual have been written in compliance with current technical norms and regulations together with our many years of knowledge and experience.

Disclaimer: DiamaPro® Systems and its affiliates take no responsibility for any damage, injury or death resulting from the incorrect or unsafe use of this product. Use of this product should be undertaken by competent persons only. It is the operator's responsibility to ensure that the following safety procedures are followed. If you are unsure, do not operate this product.

1. SAFETY

1.1. Explanation of Symbols & Instructions

Safety instructions in this manual are marked by symbols. Instructions are introduced by signal words which express the scale of the hazard.

It is essential that these instructions are adhered to and the machine is operated with caution to avoid accidents, injuries and material damage.



WARNING!

...indicates a potentially dangerous situation which if not avoided can lead to minor or light injuries.



CAUTION!

...indicates a potentially dangerous situation which if not avoided can lead to minor or light injuries.



PROHIBITION!

...indicates an immediate dangerous situation which if not avoided can lead to death or serious injuries.



ADVICE!

...emphasizes tips and recommendations as well as information for efficient and failure-free operation.

1.2. Intended Use

The machine is used for the removal of all sorts of floor coverings for example UPVC, linoleum, carpets, rubber floors as well as tiles, coatings, adhesives and parquet flooring!

The machine is NOT suited as tractor unit or for demolition work. This includes the compliance with the manufacturer's operating, maintenance and servicing conditions!

Any use beyond the intended use or other types of use is considered misuse.



WARNING! Danger due to misuse!

Misuse can lead to dangerous situations.

- Operation outside the specified limit values of the technical data.
- Bypassing or overriding of safety installations.
- Remodeling refitting or changing the construction or individual parts with the intention to alter the area of application or use of the machine.
- Use of the machine when not in perfect technical condition.
- Use of the machine in potentially explosive areas.

Claims of any sort of damages following improper use.

1.3. Owner's Obligations

The owner is a person who operates the machine for commercial or economic use or leaves it to a third person for use/application and during its use carries the legal responsibility for the protection of the user, personnel or a third person. The machine is used in the commercial sector. The owner of the machine is therefore obliged to comply with the legal responsibilities for health and safety.

The local regulations of the place of use as well as accident prevention measures of the local trade association must be adhered to.

It applies in particular that the owner:

- is informed about current health and safety regulations.
- determines during a risk assessment additional hazards which occur through specific working conditions on the operating site of the machine.
- implements in a job control statement the necessary compliance requirements for the operation of the machine on the operating site.
- regularly examines during the entire operating time that the operating instructions comply with the current status of regulations.
- that the operating instructions-if necessary- are adjusted to new regulations, standards and conditions of use.
- clearly regulates the responsibilities for the installation, operation, maintenance and cleaning of the machine.
- ensures that all staff working near or with the machine have read and understood the operating instructions. Furthermore he or she has to train all personnel in regular intervals and inform them about possible hazards.

Additionally the owner is responsible for:

- the impeccable condition of the machine.
- the servicing of the machine in the recommended maintenance intervals.
- the regular inspection of all safety installations ensuring that they are complete and in working order.

1.4. Operating Personnel

QUALIFICATION

The different tasks described in this manual request various qualifications from the persons dealing with the machine.



WARNING! Danger for persons with insufficient qualifications!

Insufficiently qualified persons can not judge the risks when operating the machine and put themselves and others at risk of serious injuries or death.

- All work must only be performed by qualified personnel.
- Insufficiently qualified persons must be kept away from the operating area.

In this manual the necessary qualifications for the persons and the different tasks are listed:

OPERATOR:

the operator has been instructed by the owner and been given the assigned tasks and has been informed about the possible hazards in case of improper behavior. Tasks which go beyond regular operation tasks can only be executed by the operator if listed in this manual and have been explicitly authorized by the owner.

TRAINED PERSONS

have been instructed by the owner and been given the assigned tasks and have been informed about the possible hazards in case of improper behavior.

QUALIFIED PERSONNEL

Qualified personnel is able to carry out assigned tasks and recognize and avoid independently possible hazards given their specialist training, knowledge and experience as well as their knowledge of relevant norms and regulations.

MANUFACTURER

Certain work can only be carried out by trained personnel of the manufacturer. Other personnel are not authorized to carry out this work. Please contact our customer service for required work.

UNAUTHORIZED PERSONS

WARNING! Danger for unauthorized persons in the operating area!

- Unauthorized persons have to be kept away from the operating area.
- If in doubt remove persons from the operating area.
- Interrupt the work as long as unauthorized persons are in the operating area.

INSTRUCTION

The owner of the machine has to regularly instruct all personnel. For better documentation an instruction protocol with the following minimum content has to be kept:

- date, content of the instruction
- name of the instructor
- signatures of the instructed and instructor

1.5. Personal Protective Equipment

When operating the machine personal protective clothing has to be worn in order to minimize health hazards.

The following protective clothing has to be worn by anybody in the operating area.



Protective work clothing.
Wear appropriate work clothing! Work clothing should fit tightly and loose garments should be avoided since they can get caught in the machine.



Protective gloves
Protective gloves to protect your hands when changing blades.



Ear protection + Protective goggles
Ear protection offers you protection from hearing damage through noise.
Protective goggles protect your eyes from floor covering flying around.



Safety shoes
Safety shoes protect your feet from bruising and from sharp objects and from slipping on slippery ground.



Respirator mask
Dust can lead to breathing complaints. When working for a long time or on dusty ground a respirator mask has to be worn to protect your respiratory tract from dust and from small particles.

1.6. Signage



WARNING! Danger with illegible signage!
With time labels and signage can become dirty or illegible so that hazards can't be recognized and necessary instructions adhered to. This means an increased risk of injury.

- Keep all safety, warning and operating instructions always in legible condition.
- Damaged labels or signage has to be replaced immediately.

The following symbols and signs can be found in the operating area. They refer to the immediate area where they have been placed.



WARNINGS
Sharp blade

Wear protective gloves when changing blades



COMMANDMENTS

Read and understand the user instructions
Wear ear protection and safety goggles
Wear appropriate work clothes
Wear safety shoes

1.7. Safety Installations



WARNING! Danger through defective safety installations!
Defective or suspended safety installations can cause severe injuries and death.

- Before work can start all safety installations have to be inspected to see whether they are functioning properly and have been correctly installed.
- Never suspend safety methods or override them.
- Make sure that all safety methods are always accessible.

1.8. Occupational Safety & Special Risks

The following paragraph explains residual risks which might be present even if the machine is used correctly.
To reduce the risk for persons and material damages and to avoid dangerous situations the listed safety information in this paragraph and in the remaining manual has to be adhered to.

Improper use



WARNING! Danger through improper use!
Make sure:

- Only use machine when in perfect technical condition. Defects are to be resolved immediately.
- Modifications to the machine are not permitted and can impair safety.
- Before regular maintenance, cleaning and repairs the power has to be switched off and secured against unintentional start-up (switch off drives).
- Never override or switch off safety installations.
- All work on the machine and/or its electrical components has to be carried out by trained personnel.
- Repair or maintenance work must only be carried out when the machine is switched off. The machine has to be secured against unintentional start-up.

Axis movements



WARNING! Danger of injury through axis movements!
Collision of persons with the machine or its tools can lead to severe injury.

Make sure:

- Unauthorized persons in the operating area are strictly prohibited!
- Safety installations and/or functions must not be switched off or overridden.
- Do not hold any body parts between moving components.
- Blades must only be changed when the machine is idle.
- Wear personal protective gear in the operating area.
- Assistants must always keep a safety distance of a minimum radius of 1 meter from the machine.

Removed materials



WARNING! Injuries through removed materials!

The removed floor covering can fly around or be thrown around unexpectedly and cause serious injury.

Make sure:

- Wear face protection or fully closed and tight fitting goggles, protective clothing, protective gloves and safety shoes.
- Seek medical attention immediately if particles have entered your eyes.
- Assistants must always keep a safety distance of a minimum radius of 1 meter from the machine.

Sharp edges and sharp corners



CAUTION! Danger of injury from sharp edges and sharp corners!

Sharp edges and sharp corners can scratch and cut into your skin.

Make sure:

- Be careful when working near sharp edges and sharp corners.
- Wear protective gloves when in doubt.

Insertion tools (knives/blades)



CAUTION! Danger of injury through improper use of tools!
Improper use of tools can cause bruising and cuts.

Make sure:

- Use tools carefully and as intended.
- Consider the weight of tools in transport.
- Wear protective gloves and safety shoes.

Working environment



CAUTION! Avoid dangerous conditions!

Do not operate machine in rain, stormy surroundings, humidity or wet areas or in explosive environments (gaseous vapours, dust or flammable materials).
Remove materials and debris which can be ignited by sparks.
Keep your working area clean and well lit.
Untidy and dark working areas increase the danger of accidents.
Keep spectators away from the working area.
Children and spectators must keep a safety distance from the working area in order not to distract the driver and not to come in contact with the machine. The driver must always be aware of who is nearby.
Also protect other persons in the working area.
Provide safety screens and protective shields to protect others from the movement of the machine and debris.
Always be aware of the position of your colleagues when the machine is in operation. Close off working area.
Colleagues must never be in front or behind the running machine. Non-compliance can lead to serious injuries or death.
Keep working area clean and tidy! Unsecured, scattered components and tools are a potential source for accidents

Start-up and operation



WARNING! Danger of injury through improper start-up and operation. Improper start-up and operation can lead to personal injury or material damage.

Make sure:

- Start-up and operation can only be executed by sufficiently trained personnel, authorized and instructed by the owner of the machine.
- Before work commences all safety installations have to be inspected to check whether they are functioning properly and have been correctly installed.
- Keep working area tidy and clean! Unsecured, scattered components and tools are a potential source for accidents

WARNING! Non-stop work; Malpositions, vibrations and machine movements cause pain and fatigue

Make sure:

- observe regular breaks

Maintenance and troubleshooting



WARNING! Danger of injury through improper maintenance and troubleshooting! Improper maintenance and troubleshooting can lead to severe personal injury and material damage.

Make sure:

- Any maintenance work and troubleshooting must only be carried out by sufficiently qualified and instructed personnel.
- Secure machine from unintentional start-up. Switch off drive!
- Provide sufficient space before starting maintenance work.
- Keep working area clean and tidy! Unsecured, scattered components and tools are a potential source for accidents.

When components need to be replaced:

- Contact DiamaPro Systems® or authorized representative.

ELECTRICAL CONNECTIONS / ELECTRICAL COMPONENTS



WARNING! Risk of death due to electric current!

Only connect the machine to the electrical values stated on the rating plate. Check before startup.

Only connect the machine to an approved power cable and plug. For Europe, approved power cables and plugs must be used. Cable Type H07BQ-F3G2,5 length max 10 m, 230ASP/Kupp. Using the machine with cables of insufficient average and / or excessive length may result in personal injury or property damage.

Have electrical equipment such as a relay, protective circuit or power line checked by an authorized electrician. If the circuit breaker trips or trips repeatedly, it can cause electrocution.

Never work with a damaged cable or plug. Worn or damaged cables or plugs should be replaced by an electrician or authorized service personnel.

Do not use the machine if the cable is damaged. Do not pull on the cable to move the machine. Using the machine with a damaged cable can cause an electric shock.

Never switch off the earthing cable or render it unusable. Using the machine in a non-earthed circuit may result in electrocution. Consult an electrician if the grounding wire is missing or if you believe that the circuit does not have adequate grounding.



The machine may only be operated on circuits with a residual current device.

When working on the machine always unplug the power plug! Maintenance, replacement or adjustment of the hydraulic fluid or components may result in personal injury to the operator and / or bystanders when the machine is plugged into the electrical outlet.

Work on electrical components of the machine may only be carried out by a qualified electrician.

Keep the cable away from the lower part of the machine so that the blade does not come into contact with it. Always keep the cable raised above the machine.

Driving over or damaging the cable through the machine may result in electric shock.

The machine is only suitable for indoor use. Risk of electric shock. Do not expose the machine to water or rain.

2. PRODUCT INFORMATION

2.1. Technical Description

SPECIAL FEATURES

The powerful motor combined with the revised HYDRAULIC-DIRECT-DRIVE ensures high forces and extremely low noise level.

The SCR-394 is self-propelled (forward and reverse) with infinitely adjustable speed.

Adjustable guide handle in six positions enables ergonomic operation depending on body size or preferred working position.

Weights can be removed easily for transportation at reduced net weight of the machine.

2.2. Technical Specifications

Dimensions	
Height H1 (handle)	26-43 in
Height H2 (transport)	23 in
Length L1 (total)	28 in
Wheel Ø	9 in
Width W1 (blade)	8 in
Width W2 (wheels)	14 in
Width W3 (handle)	17 in
Removable Weight	231 lbs
Weight	394 lbs
Power Supply	110V
Motor Size	1.5 HP
Hand-arm vibration on the control lever	8,5 m/s ²
Sound pressure at the ear of the operator 2000/14/EG	standstill / operation 73 dB(A) / 68 dB(A)

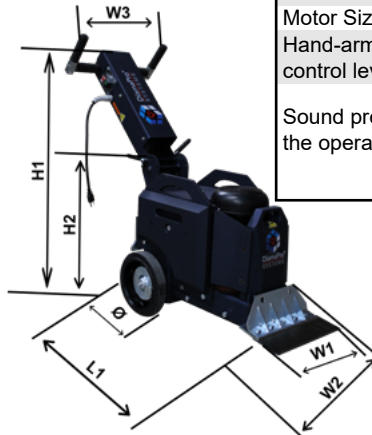

2.2. Technical Specifications

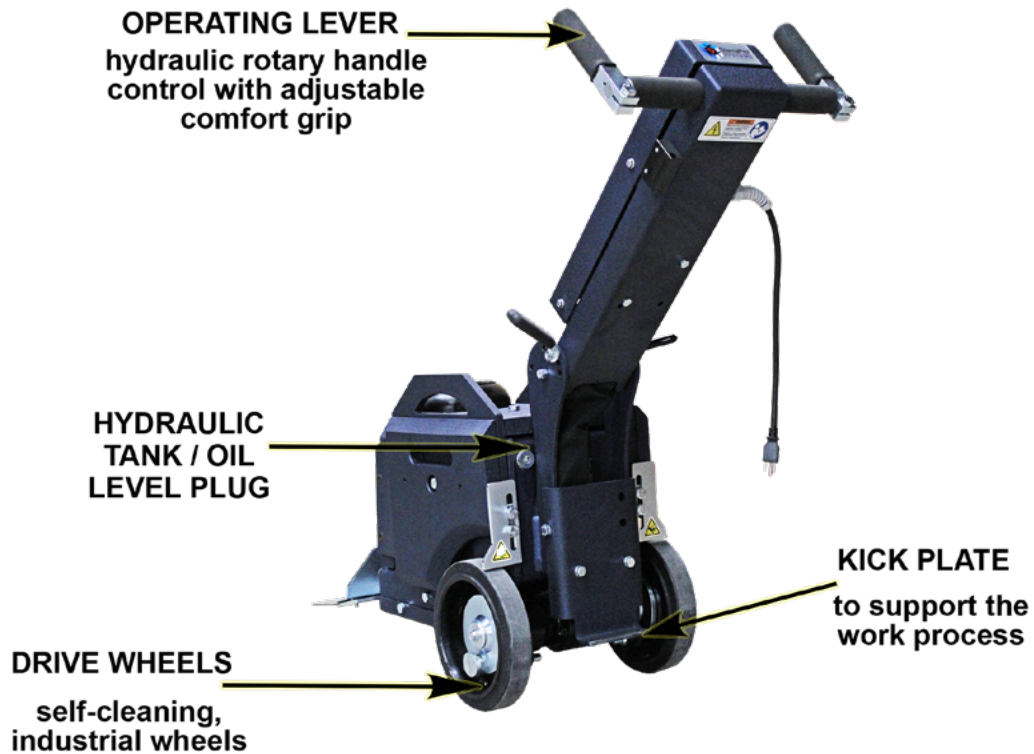
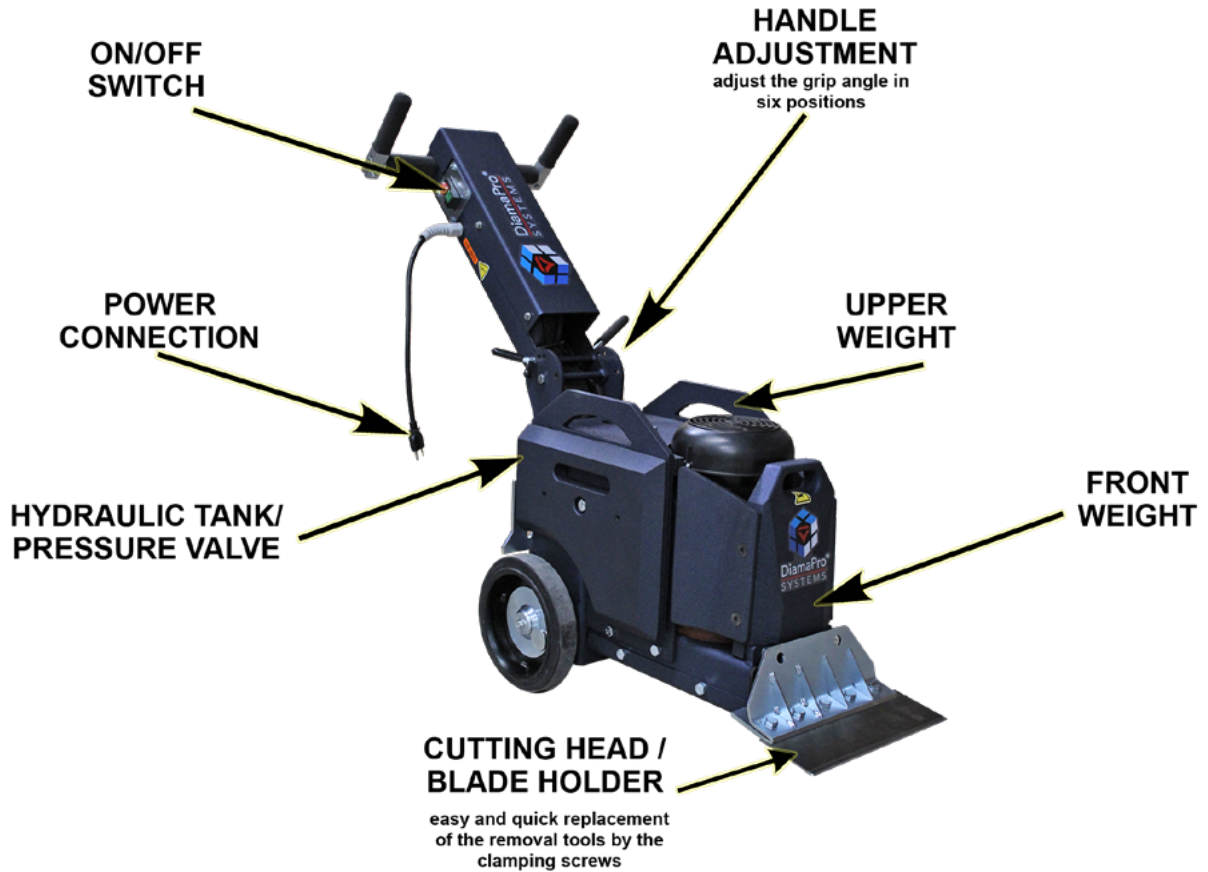

3. TRANSPORT

3.1. Raising

Always remove all counterweights and blades before loading or unloading.

Easy to lift if you can not drive the machine or have no ramp available.



ATTENTION! machine weight

Carrying or lifting the machine always with 2 people

Remove the weights -> see 4.3

Adjustment of the carrying position-> see 4.2



3.2. Loading / Unloading

With the help of a ramp, the machine can be transported over different levels.



Make sure the ramp is clean and dry, free of grease or oil.

1. Attach ramp securely to back of vehicle, making sure there is good contact.
2. Position machine at back of ramp, respectively at head of ramp.
3. Engage power switch and drive onto vehicle, respectively drive out of vehicle.

Lowering handle may be necessary for proper clearance into the back of smaller cars.

ATTENTION! Make sure ramp is secure before using.

Failure to do so could cause ramp to fall away from truck, causing damage to the machine and/or injury to the operator.

For space-saving transport, the ramp can be folded in half. The machine can be stored in a space-saving manner when out of service or for transport in vehicles.

3.3. Storage

Handle angle set in the storage position
(Handle angle adjustment, see chapter 4.2)

ATTENTION ! Do not lift the machine by the handle

Improper transport can cause damage to the machine and danger of falling. (Proper transport see above)



4. SETUP

4.1. Blade

Choice of blade

The correct blade size and the correct attachment of the blades, according to the respective floor covering or subfloor will provide the best performance of your machine.

Blade size

The harder a job is, you should select the narrowest blade to achieve optimal results.

Narrow blades usually clean the floor faster, as the machine will have less resistance as when compared to using a wider blade. Start with a narrow blade, widen the blade around the optimize cut surface.

Self-scoring U-blades

Blade bevel

Normally bevel up
blade is up for
concrete



Bevel down for
wood or soft
sub-floors.



When using self-scoring U-blades for soft floors, pre-cutting of the lining is unnecessary. Depending on the type of product to be removed and the sharpness of the blade,

it will be more difficult to control the machine.

Therefore, you should always keep the blade and the side wings/edges sharp.



Insert / replace blade

Blunt blades affect and reduce the capacity and cutting performance of the machine. Sharpen or replace the blades as needed.

Remove the power plug

CAUTION ! sharp blade Wear protective gloves



Use supplied extended wrench to keep hand safely away from the edge of the blade.

1. Place a block under the front of the machine.
2. Loosen the two hex head bolts with the extended bolt wrench and replace the blade.

It is not necessary to remove the bolts.

Be sure that the blade is far enough under the blade-holder, to insure a secure hold.

USE ONLY ORIGINAL BLADES.

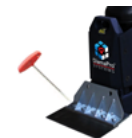

4.2. Handle angle

The guide handle is adjustable in six positions and can be individually adjusted to the desired working position.



Pull out the mains plug!

Hold both clamping levers
Unscrew the left clamping lever and remove the complete handle bolt (A).

Attention handle is not fixed !!
support with your body or by a second person

Set the handle to the desired position, push in the handle bolt (B) and tighten the clamping lever again.



4.3. Weights

For easier transport, the weights should be removed.

To remove the rear weight, remove two bolts with the wrench on both sides (A) and remove the weight (B).

To remove the front weight, loosen the two front bolts (C) with the wrench and remove the weight by the handle.

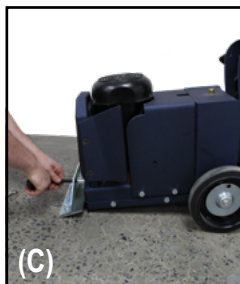

ATTENTION Weights are heavy
caution when removing and mounting.
To carry, put handle backwards - see chapter 3.1



ATTENTION ! Never lift the complete machine by the weights.
The handles on the weights are only for removing and transporting the weights themselves.

4.4. Operating lever

The angle of the operating lever can be infinitely adjusted to the desired working position.

Release lever clamp with ring spanner, adjust and tighten again.

Levers must be set to the same position on both sides.

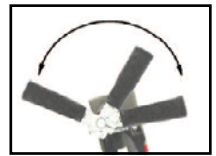

5. OPERATION

5.1. Start-up

1. Connect the extension cord to the power cord on the guide handle of the machine.
2. Insert the plug of the extension cable into the socket/ wall power supply.
3. Turn on the machine
GREEN - Start button
RED - Stop button
4. You control the machine by operating the lever
FORWARD -> Press the control lever forwards
REVERSE -> Push control lever backwards

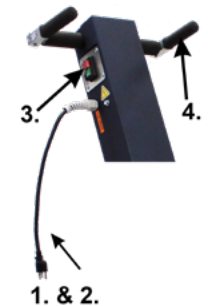

For immediate shutdown of the machine
-> **Release the control lever!**
These automatically go to the neutral position

The pressure valve is factory set and should not be adjusted.

The hydraulic oil is filled at the factory ready for operation.
Filling / replacing the hydraulic fluid -> see chapter 6 Maintenance

5.2. Safe operation

Clean work area

Loose components or tools lying around are sources of accident.
Pay attention to tidiness and cleanliness in the work area!

In case of very dusty environment and thus limiting visibility,
ensure suitable extraction / ventilation.



WARNING! Risk of injury!

Avoid collisions
Only use the machine in safe conditions.
Always keep an eye on obstacles, especially when running backwards.

Always place the power cord behind the machine on the cable holder and away from the tool so that it does not come into contact with it. Driving over or damaging the electric cable may result in electric shock.

Break / end of work

In order to avoid physical damage, regular breaks must be observed in accordance with the Technical Regulation for the Noise and Vibration Safety Regulations - TRLV.



ATTENTION! risk of injury

immobilize the machine when not in use, by pulling the power plug.

5.3. Removal of floor coverings

VCT tiles

Keep blades sharp! Keep your work area clean and clear of debris.



Always wear eye- and ear- protection when working with the machine.



Never use a blade wider than the size of the tile being removed. If goods being removed still do not come up clean or the machine jumps on top of goods, reduce blade size to a smaller blade until proper blade size is found or use a smaller portion of the blade.

Vinyl-, Rubber, PVC, Direct Glued Carpet

Scribing coverings previously and cut into sheets.

Pre-scored carpet makes machine easier to control and blades stay sharper longer.



For soft coverings, the self-scoring blade can also be used.

For best results use the scoring device "JAMAS"

Ceramic tiles

Before removing ceramic tile, tiles will have to be pre-broke with a mallet or large hammer.



On small random block styles of tile, pre-breaking may not be necessary.

Open an area large enough for machine or blade to fit in, or start from a doorway.

Keep work area clean to keep good wheel contact with floor. Use slow speed and small blades.

6. MAINTENANCE

6.1. Maintenance schedule

Maintenance locations must be outside of hazardous areas.



Maintenance work must be carried out with the machine switched off to prevent accidental start-up of the machine:
- Pull out the mains plug!

Maintenance by the user

Daily before you commence work

- Clean the wheels, they need to be free of accumulated dirt
- Checking the wheels for abrasion, they must have sufficient thread.
- Check if all safety devices are working and are installed.
- Check for hydraulic oil leaks.

WARNING! Risk of injury by hydraulic fluid!



Never visually inspect hydraulic components while the machine is running.
Never seek or touch pressurized hose assemblies.
Leaking pressurized hydraulic fluids may develop a mist or fine spray liquid that squirts or explodes on ignition

If hydraulic fluid leaks

- Keep ignition sources away
- Contact the manufacturer or specialist workshop.

- Replacement of hydraulic oil and oil filter- see chapter 6.3

Maintenance by DimaPro Systems® annually or after the first 500 hours of operation then every 1000 operating hours - according to the checklist

- Inspection of hydraulic hoses and connections
- Inspection of safety equipment
- Inspection of the screw connections
- Inspection of electrical components and connections

Requirements for the hydraulic hose according to BGR 237

Recommended inspection period

Normal requirements 12 months

Recommended replacement intervals

Normal requirements 6 years

(Operating time including a maximum of 2 years storage period)

6.2. Hydraulic oil

Operating instructions for handling hydraulic oil according to § 14 Ordinance on Hazardous Substances

Dangers for humans and the environment

Hydraulic oils are flammable. Vapors released when exposed to very high temperatures and spray can form explosive mixtures with air. There is a risk of ignition of oil-soaked clothing.

Frequent or prolonged contact with the products, even through oil-soaked clothing, can cause skin diseases, e.g. inflammation, rash, oil acne. Products exposed to high temperatures may accumulate with hazardous substances.

Water pollutant.

Protective measures and rules of conduct

Store and fill hydraulic oils only via drip pans, avoid splashing. Do not overfill drip pans with containers and do not use to store other materials. Keep away from ignition sources, do not smoke. Do not mist lubricants. Keep container closed and protect from heat.

Keep soaked cloths in non-combustible, closed containers.

Replace cleaning rags regularly.

Mark filled containers, replace defective markings.

Never use food containers or containers to be confused with them.

Hand protection: for long-term use resistant chemical protective gloves

Skin protection: Avoid contact with skin and clothing.

Immediately change soaked clothing and put on only after cleaning. Do not put smeared cloths in the pockets of work clothes. Do not use solvents, thinner, benzine or something similar for skin cleansing.

Behavior in case of danger

leak: After leakage, immediately take up with oil binder (for example Antipestol III) and place in designated waste containers; Ventilate the room well. Caution, danger of slipping on greasy soil.

fires: Have fire extinguisher available for fire class B. Do not extinguish with water. In case of fire, there is a risk of bursting of closed heated containers, therefore leave oil storage in case of danger.

escape route: See marking of escape routes and emergency exits

First aid

after skin contact: Thoroughly wash with soap and water, remove previously soaked clothes.

after eye contact: Rinse with an open eye and toward the outer eye for ten minutes in running water, visit a eye specialist.

after swallowing: Do not induce vomiting, consult a doctor.

after penetration of oil: After penetration of oil under the skin immediately consult medical attention!

Proper disposal

Collect waste in labeled non-combustible containers; Keep waste containers and empty containers closed, empty at the latest at the end of the shift or remove them from the work space.

6.2. Hydraulic oil (cont.)

Resources

Hydraulic oil	AVIA Fluid RSL 150 or compatible light liquids according to ISO 150 DIN 51524 T2
Capacity	5 Liter Order No 111 800 310 : 5-L container Order No 111 800 305 : 1-L container



ATTENTION !

Keep the hydraulic fluid clean and at the specified level.
Incompatible fluids can damage the unit or cause serious injury.



Preparation

Wear protective gloves and goggles

Level of hydraulic fluid

The machine is ready for operation ex works filled with hydraulic oil. The level is below the oil level screw

Check the hydraulic fluid level if there is a leak, damaged or broken hose or loose fitting.



Filling / replacing the hydraulic fluid

To fill up with hydraulic fluid, unscrew the oil level plug at the rear of the tank and fill up to the mark.

To replace hydraulic fluid, unscrew the oil level plug at the rear of the tank and the pressure valve at the top of the tank.

Suck out the old hydraulic oil with a special hydraulic oil suction device.



A container of about 5 liters is needed to drain the liquid.

Fill with new oil.



ATTENTION! Do not overfill. Watch marking

Assemble the oil level screw on the rear of the tank.

RECOMMENDED REPLACEMENT PARTS

PART NUMBER	DESCRIPTION	QTY.
DP-SCR-10435	Wheel Motor Fitting, 45 Degree for DiamoPro SCR-394	1
DP-SCR-10437	Wheel Motor Fitting, 90 Degree for DiamoPro SCR-394	1
DP-SCR-10425	Adapter for DiamoPro SCR-394	2
DP-SCR-10442	Pump Drive Belt for DiamoPro SCR-394	1
DP-SCR-10226	Cutting Head Flange Bearing for DiamoPro SCR-394	1
DP-SCR-10445	Drive Wheel for DiamoPro SCR-394	2
DP-SCR-10446	Hub Retainer and Bolt for DiamoPro SCR-394	2
DP-SCR-10303	Wheel Pin for DiamoPro SCR-394	2
DP-SCR-10447	Magnet for Wheel Pin for DiamoPro SCR-394	2
DP-SCR-10426	Molded Pigtail for DiamoPro SCR-84 and SCR-394	1
DP-SCR-10427	Strain Relief for DiamoPro SCR-84 and SCR-394	1
DP-SCR-10251	On/Off Switch for DiamoPro SCR-84 and SCR-394	1
DP-SCR-10449	Flat Rubber Grip for DiamoPro SCR-84 and SCR-394	1
DP-SCR-10448	Round Rubber Grip for DiamoPro SCR-84 and SCR-394	1

HYDRAULIC COMPONENTS

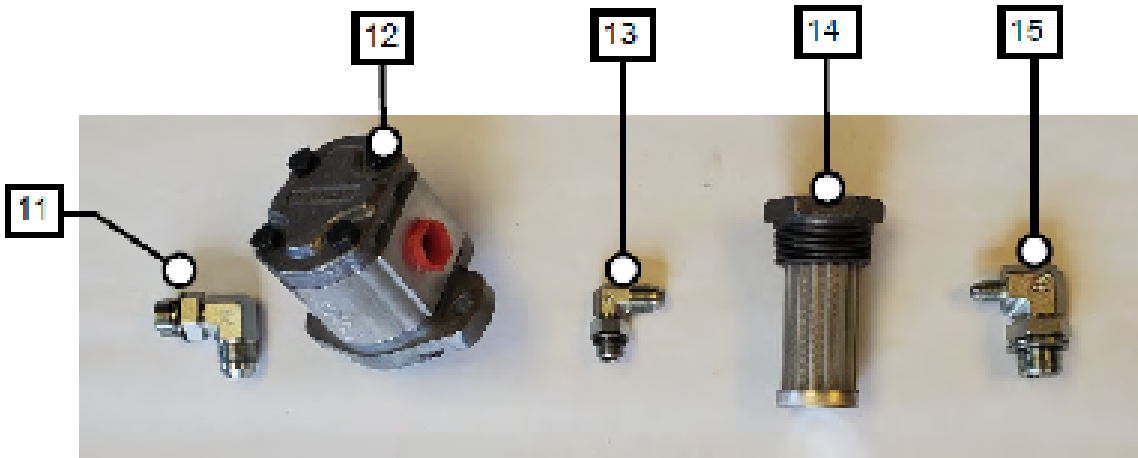
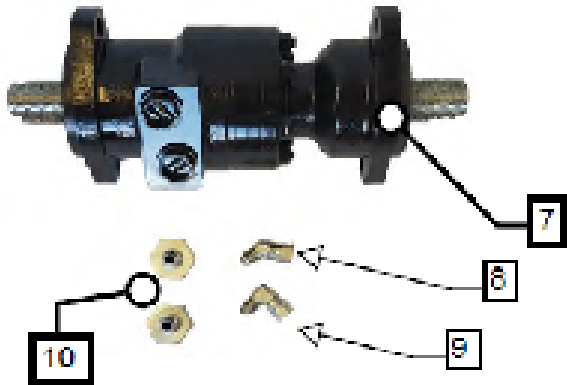
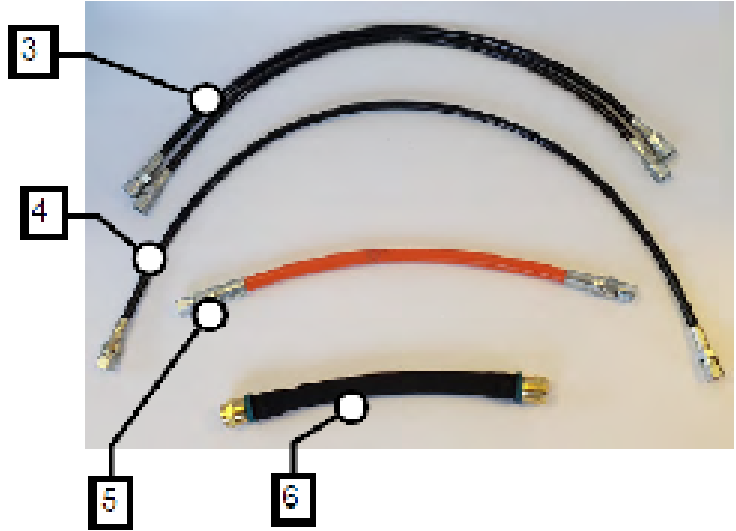
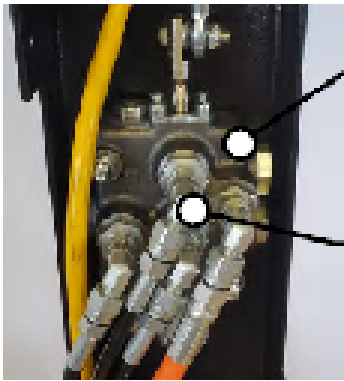

HYDRAULIC COMPONENTS

REF. #	PART NUMBER	DESCRIPTION	QTY.
1	DP-SCR-10084	Single Spool Valve for DiamaPro SCR-394	1
2	DP-SCR-10430	Valve Fitting Kit for DiamaPro SCR-394	1
3	DP-SCR-10431	Wheel Motor Lines for DiamaPro SCR-394	2
4	DP-SCR-10432	Pressure Line for DiamaPro SCR-394	1
5	DP-SCR-10433	Return Line for DiamaPro SCR-394	1
6	DP-SCR-10434	Suction Line for DiamaPro SCR-394	1
7	DP-SCR-10221	Wheel Motor for DiamaPro SCR-394	1
8	DP-SCR-10435	Wheel Motor Fitting, 45 Degree for DiamaPro SCR-394	1
9	DP-SCR-10437	Wheel Motor Fitting, 90 Degree for DiamaPro SCR-394	1
10	DP-SCR-10425	Adapter for DiamaPro SCR-394	2
11	DP-SCR-10438	Suction Fitting for DiamaPro SCR-394	1
12	DP-SCR-10238	Hydraulic Pump for DiamaPro SCR-394	1
13	DP-SCR-10439	Pressure Fitting for DiamaPro SCR-394	1
14	DP-SCR-10120	Suction Strainer for DiamaPro SCR-394	1
15	DP-SCR-10440	Return Fitting for DiamaPro SCR-394	1

ELECTRICAL COMPONENTS

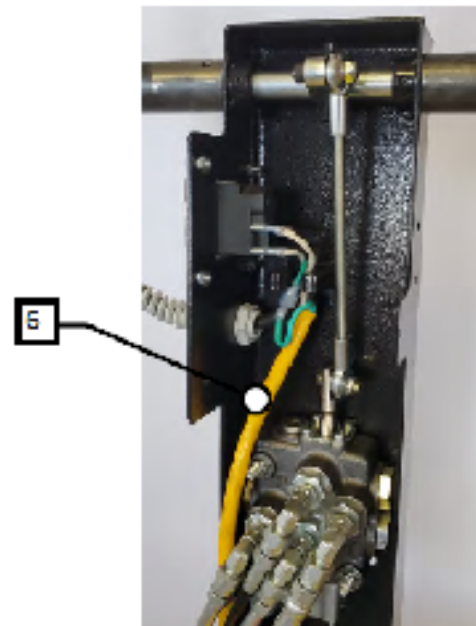
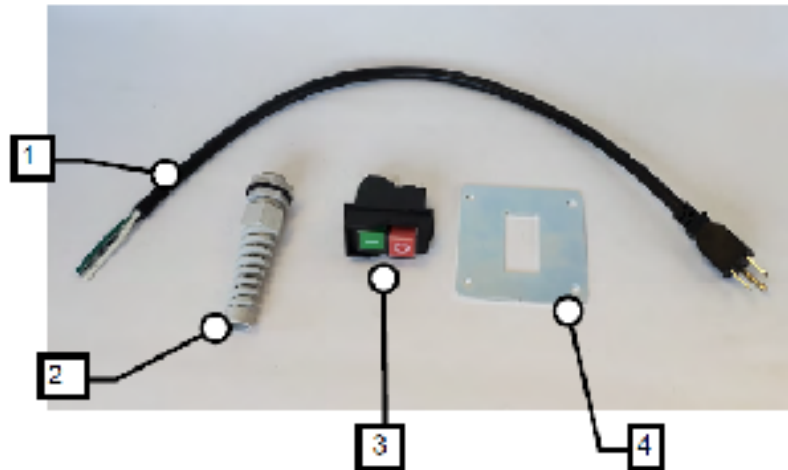

REF. #	PART NUMBER	DESCRIPTION	QTY.
1	DP-SCR-10426	Molded Pigtail for DiamoPro SCR-84 and SCR-394	1
2	DP-SCR-10427	Strain Relief for DiamoPro SCR-84 and SCR-394	1
3	DP-SCR-10251	On/Off Switch for DiamoPro SCR-84 and SCR-394	1
4	DP-SCR-10276	Switch Plate For DiamoPro SCR-394	1
5	DP-SCR-10428	Electric Motor for DiamoPro SCR-394	1
6	DP-SCR-10429	Inside Power Cord for DiamoPro SCR-394	1

CUTTING HEAD & DRIVE COMPONENTS

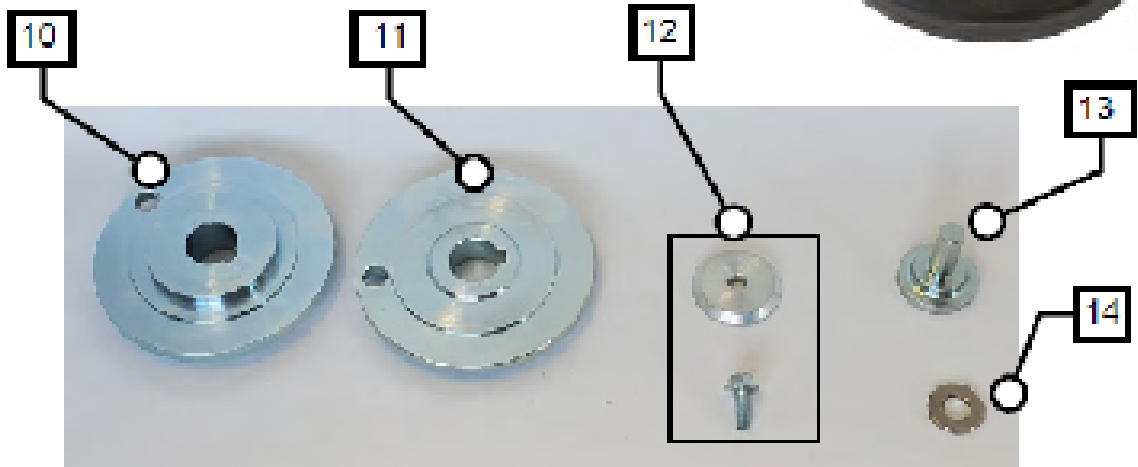
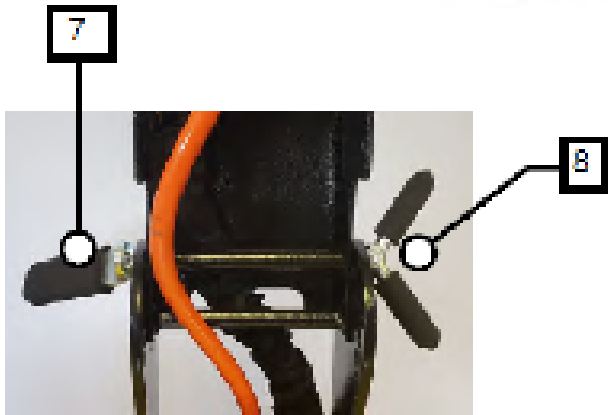
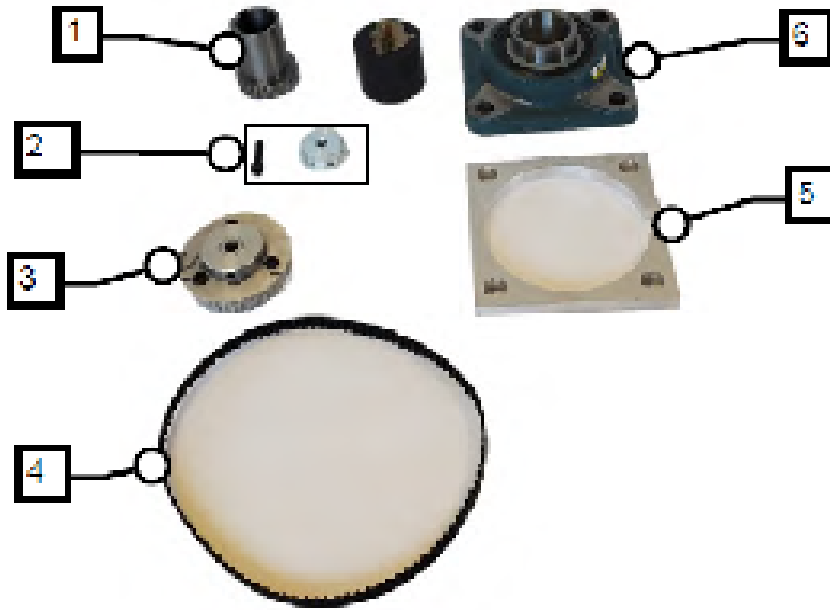

CUTTING HEAD & DRIVE COMPONENTS

REF. #	PART NUMBER	DESCRIPTION	QTY.
1	DP-SCR-10224	Eccentric for DiamoPro SCR-394	1
2	DP-SCR-10297	Eccentric Retainer and Bolt for DiamoPro SCR-394	1
3	DP-SCR-10441	Pump Pulley for DiamoPro SCR-394	1
4	DP-SCR-10442	Pump Drive Belt for DiamoPro SCR-394	1
5	DP-SCR-10236	Bearing Spacer for DiamoPro SCR-394	1
6	DP-SCR-10226	Cutting Head Flange Bearing for DiamoPro SCR-394	1
7	DP-SCR-10443	Locking Handle for DiamoPro SCR-394	1
8	DP-SCR-10444	T-Bolt for DiamoPro SCR-394	1
9	DP-SCR-10445	Drive Wheel for DiamoPro SCR-394	2
10	DP-SCR-10300	Inside Wheel Hub for DiamoPro SCR-394	1
11	DP-SCR-10301	Outside Wheel Hub for DiamoPro SCR-394	1
12	DP-SCR-10446	Hub Retainer and Bolt for DiamoPro SCR-394	2
13	DP-SCR-10303	Wheel Pin for DiamoPro SCR-394	2
14	DP-SCR-10447	Magnet for Wheel Pin for DiamoPro SCR-394	2

MISCELLANEOUS COMPONENTS

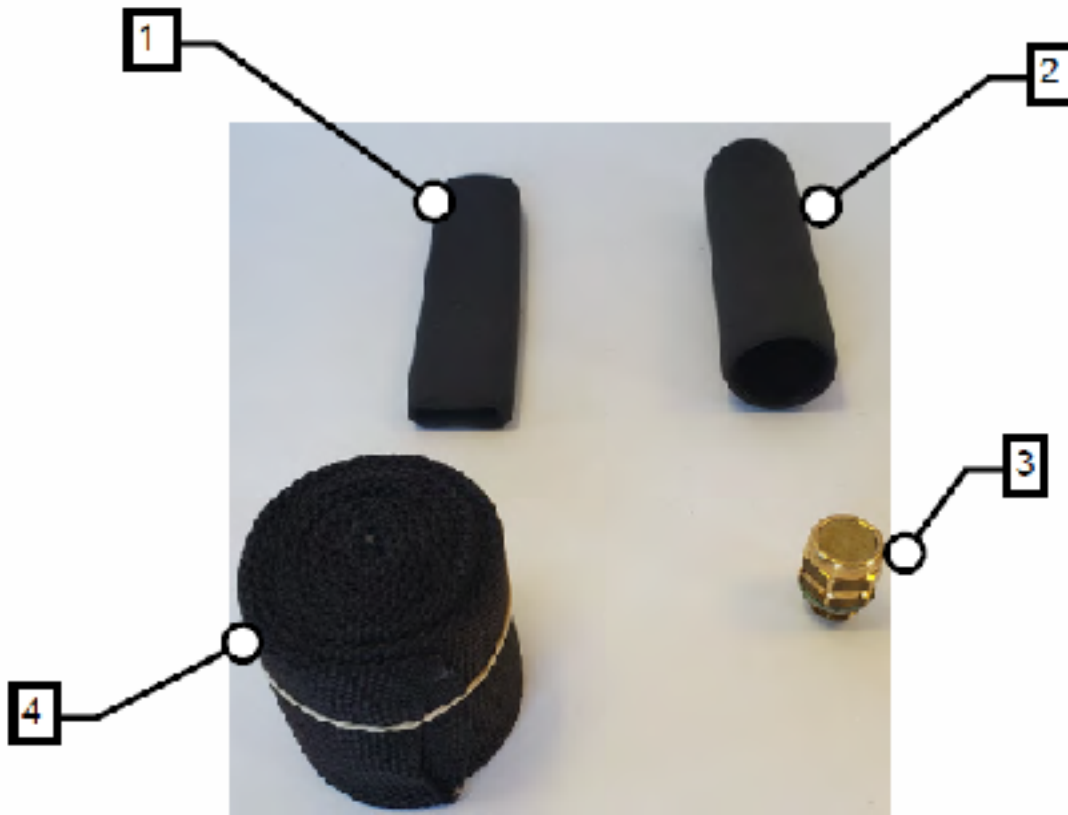

REF. #	PART NUMBER	DESCRIPTION	QTY.
1	DP-SCR-10449	Flat Rubber Grip for DiamoPro SCR-84 and SCR-394	1
2	DP-SCR-10448	Round Rubber Grip for DiamoPro SCR-84 and SCR-394	4
3	DP-SCR-10450	Tank Vent for DiamoPro SCR-394	1
4	DP-SCR-10116	Hose Sleeve for DiamoPro SCR-394	1

ADDITIONAL COMPONENTS

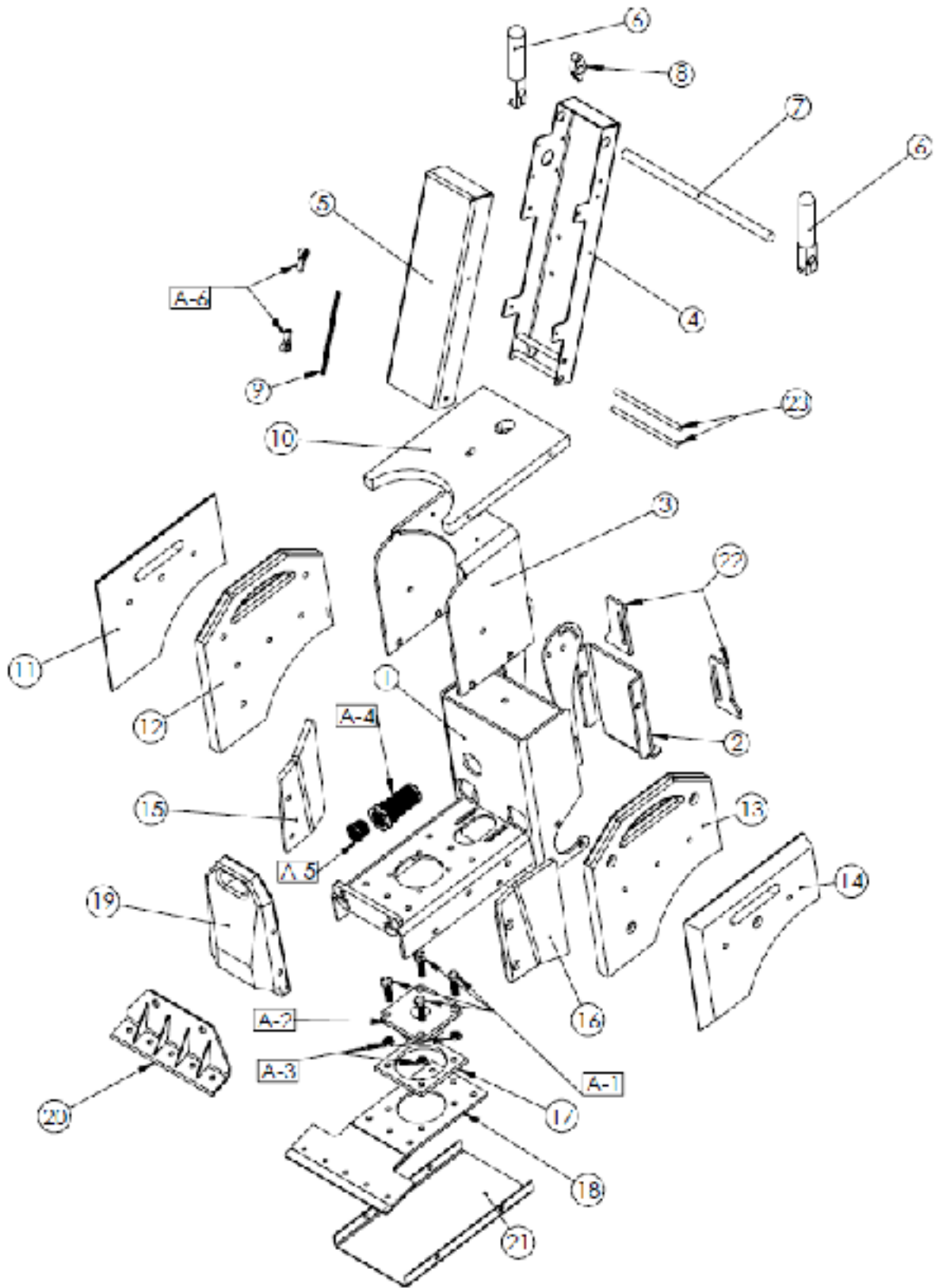

ADDITIONAL COMPONENTS

REF. #	PART NUMBER	DESCRIPTION	QTY.
1	DP-SCR-10133	Frame for DiamoPro SCR-394	1
2	DP-SCR-10171	Kick Plate for DiamoPro SCR-394	1
3	DP-SCR-10237	Shroud for DiamoPro SCR-394	1
4	DP-SCR-10160	Lower Handle for DiamoPro SCR-394	1
5	DP-SCR-10163	Upper Handle for DiamoPro SCR-394	1
6	DP-SCR-10158	Hand Grip for DiamoPro SCR-394	2
7	DP-SCR-10159	Handle Axle for DiamoPro SCR-394	1
8	DP-SCR-10168	Valve Cam for DiamoPro SCR-394	1
9	DP-SCR-10169	Threaded Rod for DiamoPro SCR-394	1
10	DP-SCR-10217	Saddle Top for DiamoPro SCR-394	1
11	DP-SCR-10219	Right Auxiliary Weight for DiamoPro SCR-394	1
12	DP-SCR-10269	Right Saddle Weight for DiamoPro SCR-394	1
13	DP-SCR-10270	Left Saddle Weight for DiamoPro SCR-394	1
14	DP-SCR-10218	Left Auxiliary Weight for DiamoPro SCR-394	1
15	DP-SCR-10227	Right Bent Side Wing for DiamoPro SCR-394	1
16	DP-SCR-10228	Left Bent Side Wing for DiamoPro SCR-394	1
17	DP-SCR-10236	Bearing Spacer for DiamoPro SCR-394	1
18	DP-SCR-10235	Cutting Head for DiamoPro SCR-394	1
19	DP-SCR-10174	Cast Weight for DiamoPro SCR-394	1
20	DP-SCR-10232	Blade Clamp for DiamoPro SCR-394	1
21	DP-SCR-10152	Bottom Cover for DiamoPro SCR-394	1
22	DP-SCR-10229	Wheel Cleaner for DiamoPro SCR-394	2
23	DP-SCR-10172	Handle Pin for DiamoPro SCR-394	2

ANCILLARY PARTS

REF. #	PART NUMBER	DESCRIPTION	QTY.
A-1	DP-SCR-10253	Hex Head Bolt for DiamoPro SCR-394	4
A-2	DP-SCR-10226	Cutting Head Flange Bearing for DiamoPro SCR-394	1
A-3	DP-SCR-10259	Nyloc Half Nut for DiamoPro SCR-394	4
A-4	DP-SCR-10120	Suction Strainer for DiamoPro SCR-394	1
A-5	DP-SCR-10260	Suction Strainer Adapter for DiamoPro SCR-394	1
A-6	DP-SCR-10145	Rod End Bearings for DiamoPro SCR-394	2

Customer Acknowledgment and Assumption of Responsibility for Modification to any Product.

Customer expressly acknowledges that modification of any equipment, machines, or other products purchased from Niagara Machine, Inc. ("Niagara"), including but not limited to DiamaPro Systems Products (collectively, "Products") through the attempted or actual use or misuse, adjustment, alteration, application of additional components, removal of provided components, repairs or attempted repairs by Customer (collectively, "Modifications") can lead to Product malfunction causing serious risks. Such risks include, but are not limited to, Product damage, bodily injury, death, or loss of or damage to property. Customer agrees that Customer is solely responsible for any Modifications Customer performs on any Product purchased from Niagara, and that Niagara is not responsible and will not be held liable for any claims, damages, or injury arising from Modifications by Customer, including Customer's employees, subcontractors, agents, representatives, affiliates, and assigns, to any Product purchased from Niagara. Customer further acknowledges and agrees that any Modification(s) to a Product may, at DiamaPro Systems' and/or Niagara's election, void any warranty applicable to the Product.

Customer agrees that, to the greatest extent permitted by law, Customer shall indemnify, hold harmless and, at Niagara's request, defend (with counsel reasonably approved by Niagara), Niagara, Niagara's parent, subsidiaries, affiliates and the officers, directors, employees and agents of Niagara (individually and collectively "Niagara Indemnitees") from and against, and pay or reimburse them for any and all third-party claims, losses, damages, liabilities, lawsuits and expenses (including reasonable attorneys' fees) relating to bodily injury, death, or loss of or damage to property caused by or arising from any Modification to a Product by Customer, its employees, subcontractors, agents, representatives, affiliates, and assigns (individually and collectively, "Customer Group"), with respect to the Products Customer purchases from Niagara.

Customer acknowledges that Customer has read and understands these terms, and voluntarily assumes full and sole responsibility for any and all effects arising from any Modification to a Product by Customer Group.



DiamaPro®

SYSTEMS

DiamaPro® Systems
3343 Peachtree Road NE
Suite 145 #24
Atlanta, GA 30326
470-977-2323